

## Black & White Immunoplate

(#31396/31496/31196/31296)

### 1. Description

SPL provides high quality 96-well plates suitable for various high throughput assays. Fluorescence and luminescence assays have been successfully tested with SPL 96 Well Microplates by many high throughput laboratories. SPL 96-well microplates have a characteristic feature of high signal with low background.

- **White plates** provide maximum reflection and minimum cross-talk for luminescence assay.
- **Black plates** are designed for minimum light scattering and cross-talk during fluorescence assay.
- **Maxibinding** : Modified polystyrene surface for higher binding capacity for proteins and other molecules with both hydrophilic and hydrophobic regions. (Recommended for most ELISA experiments)
- **Unibinding** : Suitable for adsorption of hydrophobic molecules.(Antigen ELISA)

### 2. Features

- ❖ Suitable for fluorescence assay, luminescence assay
- ❖ 2 type surface
- ❖ Individual lids provided for each plate (Black Plate with black lid, White plate with transparent lid)
- ❖ Plate type (96well per plate)
- ❖ HTS (High-Throughput Screening) compatible
- ❖ Flat bottom
- ❖ Raised rims on the wells
- ❖ Alphanumeric labeling
- ❖ Designed for easy handling and automation

### 3. Product Range

Cat.No.	Material	Plate Color	Surface Type	External Dimension w x l x h(mm)	Bottom Surface Area (cm <sup>2</sup> )	Total Vol. (μl)	Working Vol. (μl)	Packaging
31396	PS	White	Maxibinding	85.4 x 127.6 x 14.4	0.33	300	200	10 / 100
31496	PS	Black	Maxibinding	85.4 x 127.6 x 14.4	0.33	300	200	10 / 100
31196	PS	White	Unibinding	85.4 x 127.6 x 14.4	0.33	300	200	10 / 100
31296	PS	Black	Unibinding	85.4 x 127.6 x 14.4	0.33	300	200	10 / 100

### 4. Certification

SPL Life Sciences hereby certifies that the product identified above, inspected to be in compliance with product quality specification and requirements as documented in our ISO 9001:2015 Quality Management System (K-QA-Q031478) in Korea.

SPL-TDS-BWIP

5. Specifications & Technical Drawing

- Specifications

Dimensions				Material (Resin)	Packaging		
Lid		Plate				Well	
Length:	85.40 mm	Length:	85.40 mm	Diameter:	6.50 mm	Crystal-grade polystyrene (PS)	▪ Pieces/Sleeve: 10 ▪ Pieces/Case: 100
Width:	127.60 mm	Width:	127.60 mm	Depth:	11.40 mm		
Height:	9.00 mm	Height:	14.40 mm	Center to Center:	9.00 mm		
		Growth Area:	9.60 cm <sup>2</sup>				

- Technical Drawing

Plate

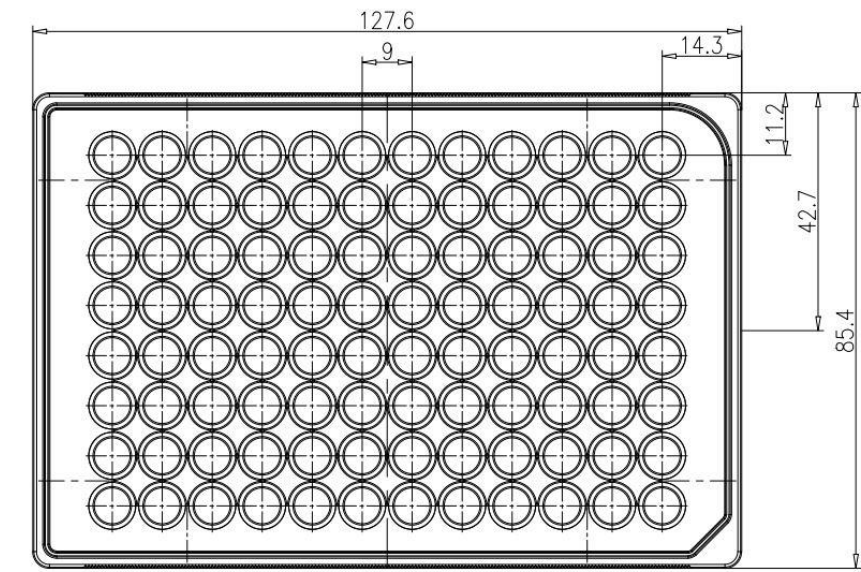

Bottom

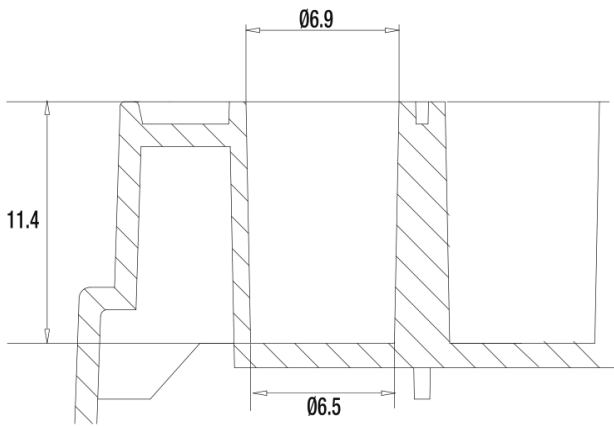

[www.spllifesciences.com](http://www.spllifesciences.com)

For technical assistance, contact SPL R&D Center at:  
Tel: +82-31-533-4800; Fax: +82-31-533-1430; e-mail: [spl@ispl.co.kr](mailto:spl@ispl.co.kr)  
To place an order, contact your local distributor or  
Tel: +82-31-533-4800; Fax: +82-31-533-1430; e-mail: [business@ispl.co.kr](mailto:business@ispl.co.kr)

SPL-TDS-BWIP

For Research Use Only. Not intended for use in diagnostic or therapeutic procedures.  
© SPL Life Sciences Co., Ltd., Version 5, November 20<sup>th</sup>, 2018